



Technical Support Note

Title: Single Piece Compact Probe vs Two-Piece Extended Probe

TSN Number: 03

File:S:\Bridge_Analyzers\Customer_Service_Documentation\Technical_Support_Notes\
03 Compact & Ext Probes.docx

Created by: R. Schrader

Last Revision Date: 22-July-10

Beginning on 7/1/2007, Bridge standardized on a compact, single piece tailpipe probe for all exhaust gas analyzer products. The configuration of the current and previous tailpipe probes are shown below. Customers having the longer two-piece probe are recommended to upgrade their probes to the newer, compact design for more convenience and better operation.

Both probe types are interchangeable, and do not require any changes to be made to the gas analyzer for compatibility.

Current Compact Single Piece Tailpipe Probe

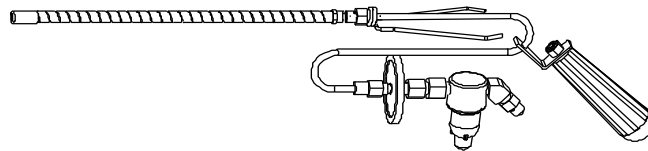

Earlier 2-Piece Extended Tailpipe Probe

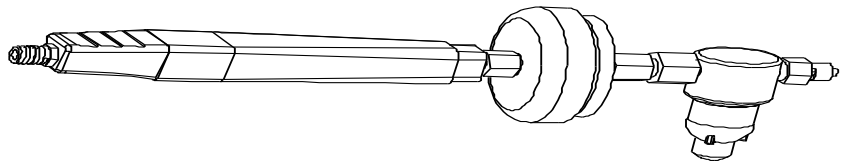
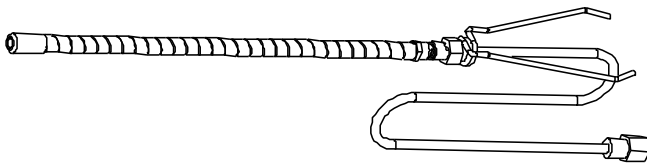

Bridge Analyzers, Inc.
PO Box 39325
Solon, Ohio 44139 USA

(510) 337-1605 office
(216) 274-9262 fax
support@bridgeanalyzers.com